

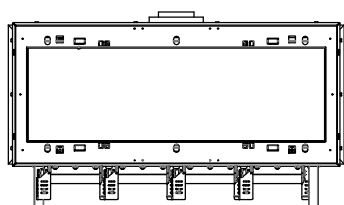

110-200 Indoor-Outdoor Double Glass - Flush

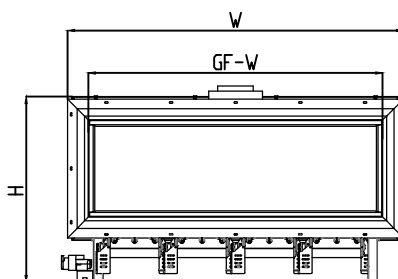

Indoor Front View



Outdoor Front View

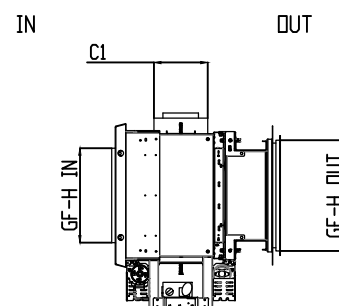

Side View

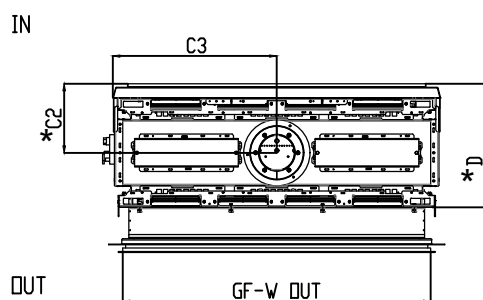

Top View

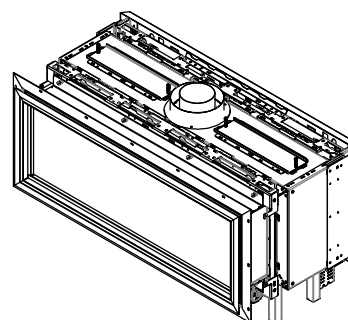

Model	(H) Height	(W) Width	(D) fixed Depth	C1	C2	C3	Glass Opening	
							(GF) IN	(GF) OUT
110	27 $\frac{3}{16}$ "	49 $\frac{1}{8}$ "	18 $\frac{1}{16}$ "	7 $\frac{7}{8}$ "	10 $\frac{1}{16}$ "	23 $\frac{15}{16}$ "	43 $\frac{5}{8}$ " W X 13 $\frac{3}{4}$ " H	45" W X 16 $\frac{3}{16}$ " H
130	27 $\frac{3}{16}$ "	55 $\frac{13}{16}$ "	18 $\frac{1}{16}$ "	7 $\frac{7}{8}$ "	10 $\frac{1}{16}$ "	27 $\frac{5}{16}$ "	50 $\frac{5}{16}$ " W X 13 $\frac{3}{4}$ " H	51 $\frac{11}{16}$ " W X 16 $\frac{3}{16}$ " H
150	27 $\frac{3}{16}$ "	65 $\frac{5}{8}$ "	18 $\frac{1}{16}$ "	7 $\frac{7}{8}$ "	10 $\frac{1}{16}$ "	32 $\frac{3}{16}$ "	60 $\frac{3}{16}$ " W X 13 $\frac{3}{4}$ " H	61 $\frac{9}{16}$ " W X 16 $\frac{3}{16}$ " H
170	27 $\frac{3}{16}$ "	73 $\frac{1}{2}$ "	18 $\frac{1}{16}$ "	7 $\frac{7}{8}$ "	10 $\frac{1}{16}$ "	36 $\frac{1}{8}$ "	68 $\frac{1}{16}$ " W X 13 $\frac{3}{4}$ " H	69 $\frac{7}{16}$ " W X 16 $\frac{3}{16}$ " H
200	27 $\frac{3}{16}$ "	82 $\frac{15}{16}$ "	18 $\frac{1}{16}$ "	7 $\frac{7}{8}$ "	10 $\frac{1}{16}$ "	40 $\frac{3}{4}$ "	77 $\frac{1}{2}$ " W X 13 $\frac{3}{4}$ " H	78 $\frac{7}{8}$ " W X 16 $\frac{3}{16}$ " H

* Dimensions includes $\frac{1}{2}$ " lip (for drywall)

** Dimensions includes 2 X $\frac{1}{2}$ " lip (for drywall)

Note : 1. Drawings are not to Scale

2. All dimensions in inches



110-200 Indoor-Outdoor Double Glass - Flush

Minimum depth

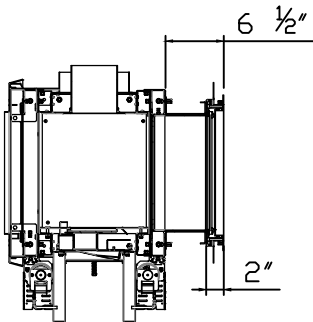
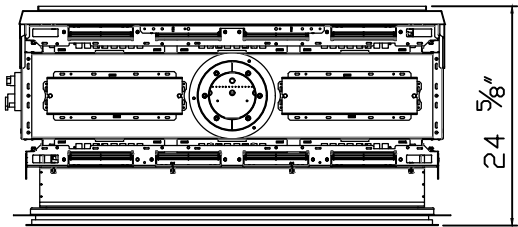

Maximum depth

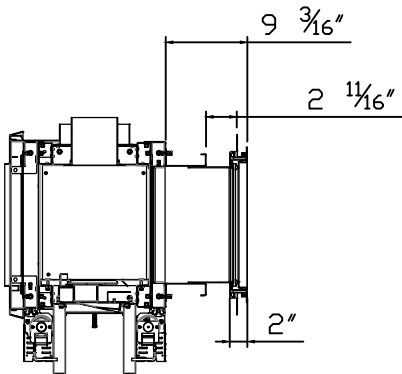
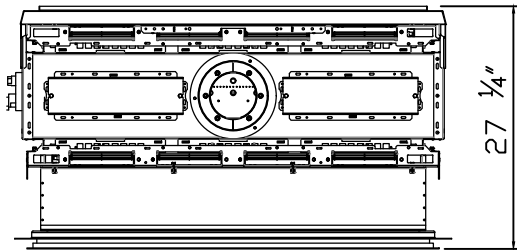

Note : 1. Drawings are not to Scale
2. All dimensions in inches



110-200 Indoor-Outdoor Double Glass - Flush

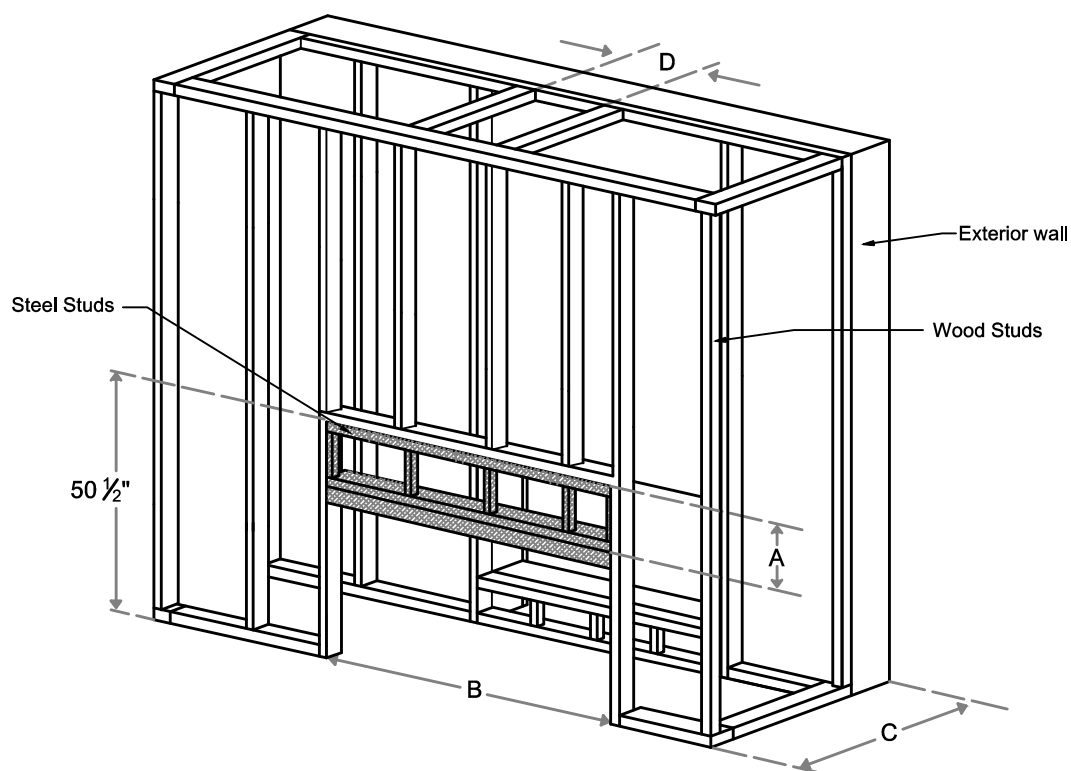

Model	A	B	C		D
			MIN	MAX	
110	22 $\frac{7}{16}$ "	53 $\frac{1}{8}$ "	24"	26 $\frac{5}{8}$ "	Refer to pipe manufacturer's firestop dimensions
130	22 $\frac{7}{16}$ "	59 $\frac{13}{16}$ "	24"	26 $\frac{5}{8}$ "	Refer to pipe manufacturer's firestop dimensions
150	22 $\frac{7}{16}$ "	69 $\frac{1}{16}$ "	24"	26 $\frac{5}{8}$ "	Refer to pipe manufacturer's firestop dimensions
170	22 $\frac{7}{16}$ "	77 $\frac{9}{16}$ "	24"	26 $\frac{5}{8}$ "	Refer to pipe manufacturer's firestop dimensions
200	22 $\frac{7}{16}$ "	87"	24"	26 $\frac{5}{8}$ "	Refer to pipe manufacturer's firestop dimensions

Note : 1. Drawings are not to Scale
2. All dimensions in inches





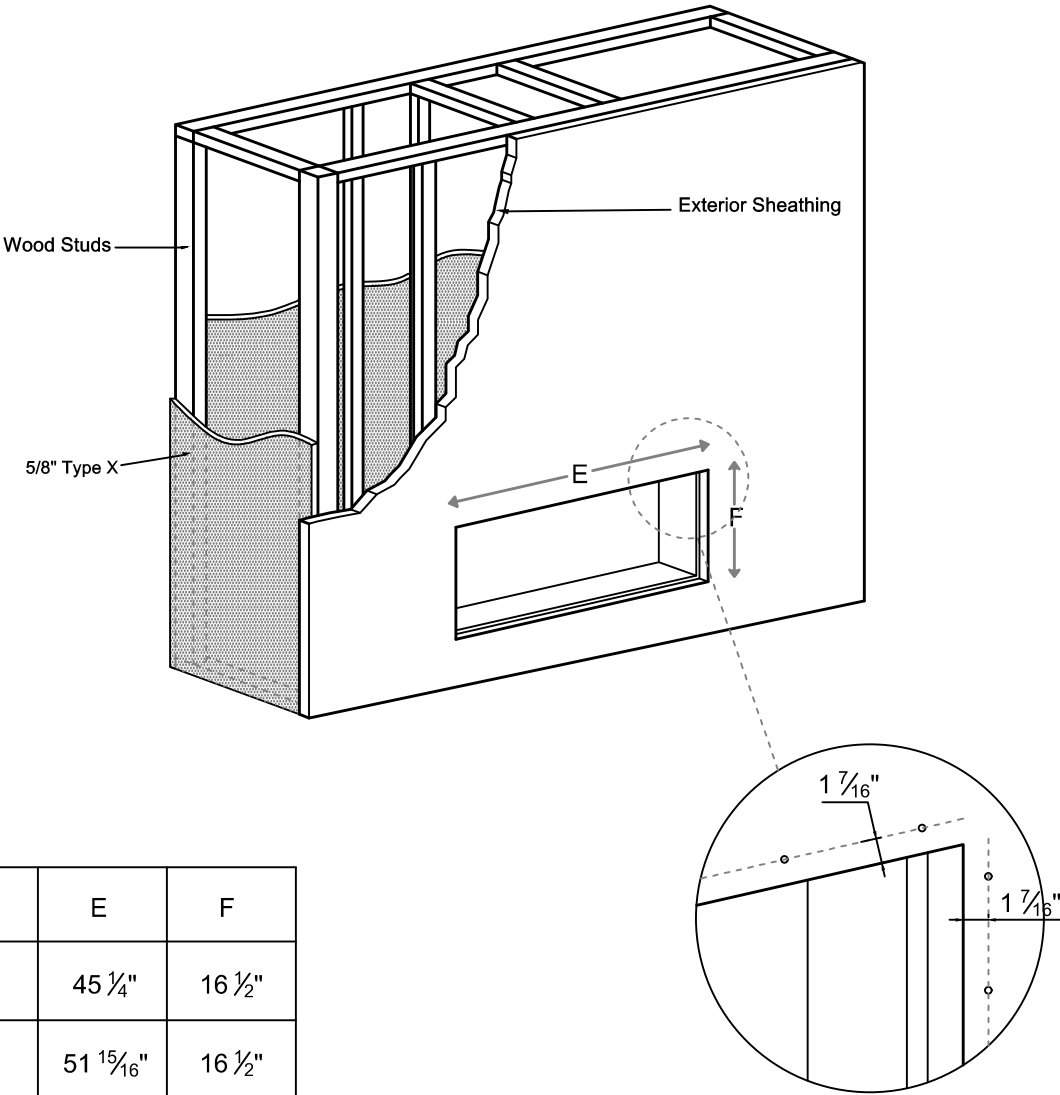

110-200 Indoor-Outdoor Double Glass - Flush



Model	E	F
110	45 1/4"	16 1/2"
130	51 15/16"	16 1/2"
150	61 13/16"	16 1/2"
170	69 13/16"	16 1/2"
200	79 1/8"	16 1/2"

Note : 1. Drawings are not to Scale
2. All dimensions in inches

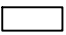
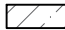
LEGEND

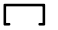
-  5/8" Type X
-  Steel
-  Wood
-  Glass
-  Wood Studs
-  Steel Studs



110-200 Indoor-Outdoor Double Glass - Flush

