

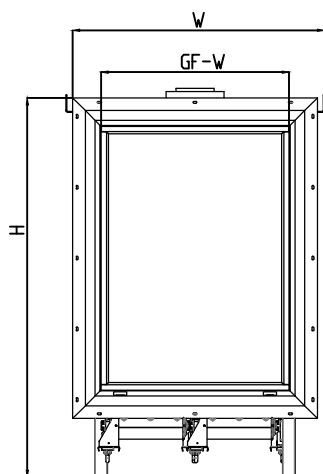

60X80 Indoor-Outdoor Double Glass - Flush

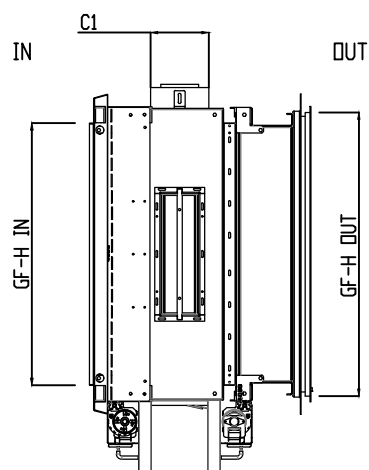

Outdoor Front View



Side View

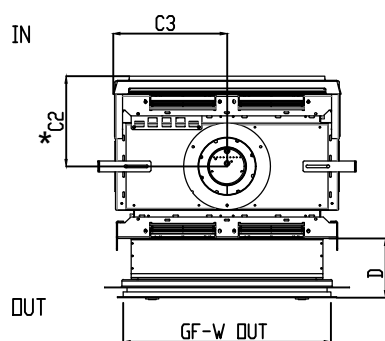

Top View

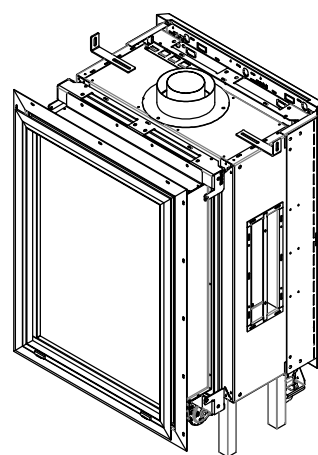

Model	(H) Height	(W) Width	(D) fixed Depth	C1	C2	C3	Glass Opening	
							(GF) IN	(GF) OUT
60x80	42 $\frac{1}{8}$ "	27 $\frac{13}{16}$ "	18 $\frac{1}{16}$ "	6 $\frac{7}{16}$ "	10 $\frac{1}{16}$ "	12 $\frac{1}{2}$ "	21 $\frac{3}{4}$ " W X 29 $\frac{1}{8}$ " H	23 $\frac{1}{8}$ " W X 31 $\frac{9}{16}$ " H

* Dimensions includes $\frac{1}{2}$ " lip (for drywall)

** Dimensions includes 2 X $\frac{1}{2}$ " lip (for drywall)

Note : 1. Drawings are not to Scale

2. All dimensions in inches

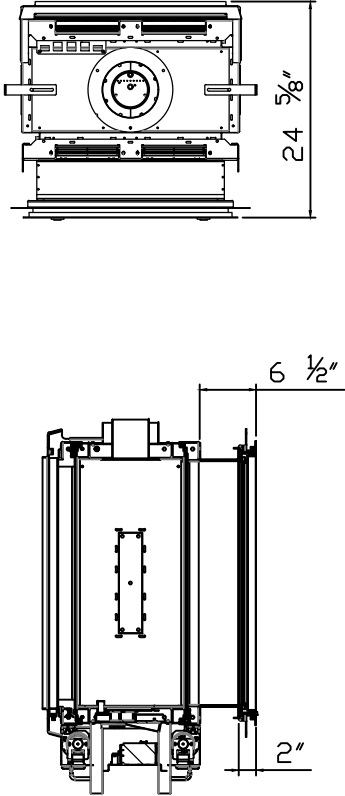
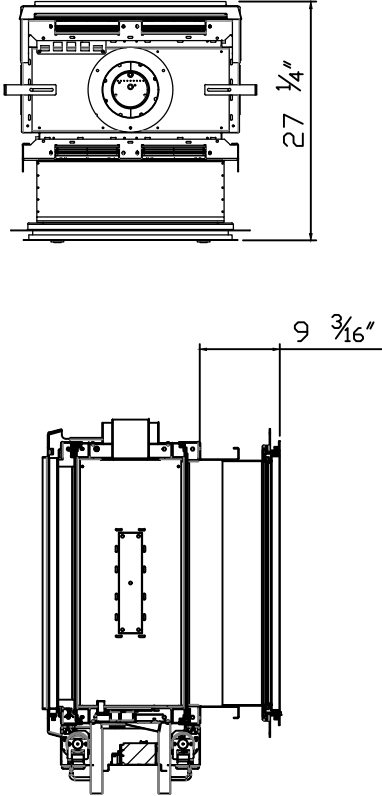

60X80 Indoor-Outdoor Double Glass - Flush

Minimum depth	Maximum depth
	

Note : 1. Drawings are not to Scale
2. All dimensions in inches



60X80 Indoor-Outdoor Double Glass - Flush

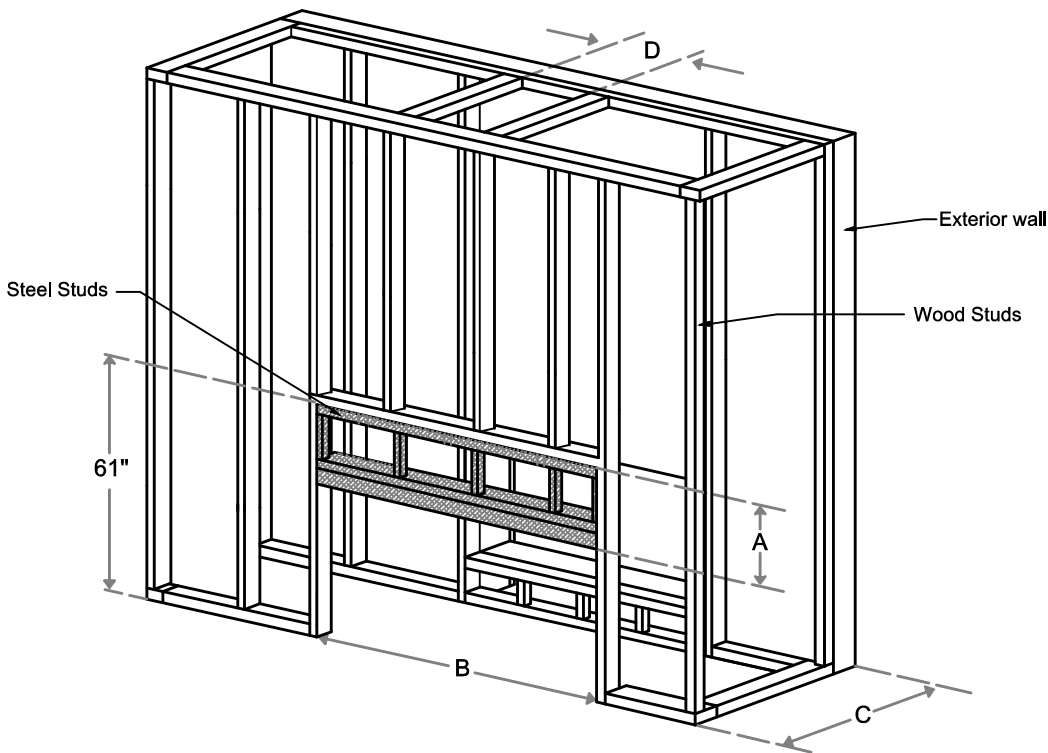

Model	A	B	C		D
			MIN	MAX	
60x80	18"	31 13/16"	24"	26 5/8"	Refer to pipe manufacturer's firestop dimensions

Note : 1. Drawings are not to Scale
2. All dimensions in inches





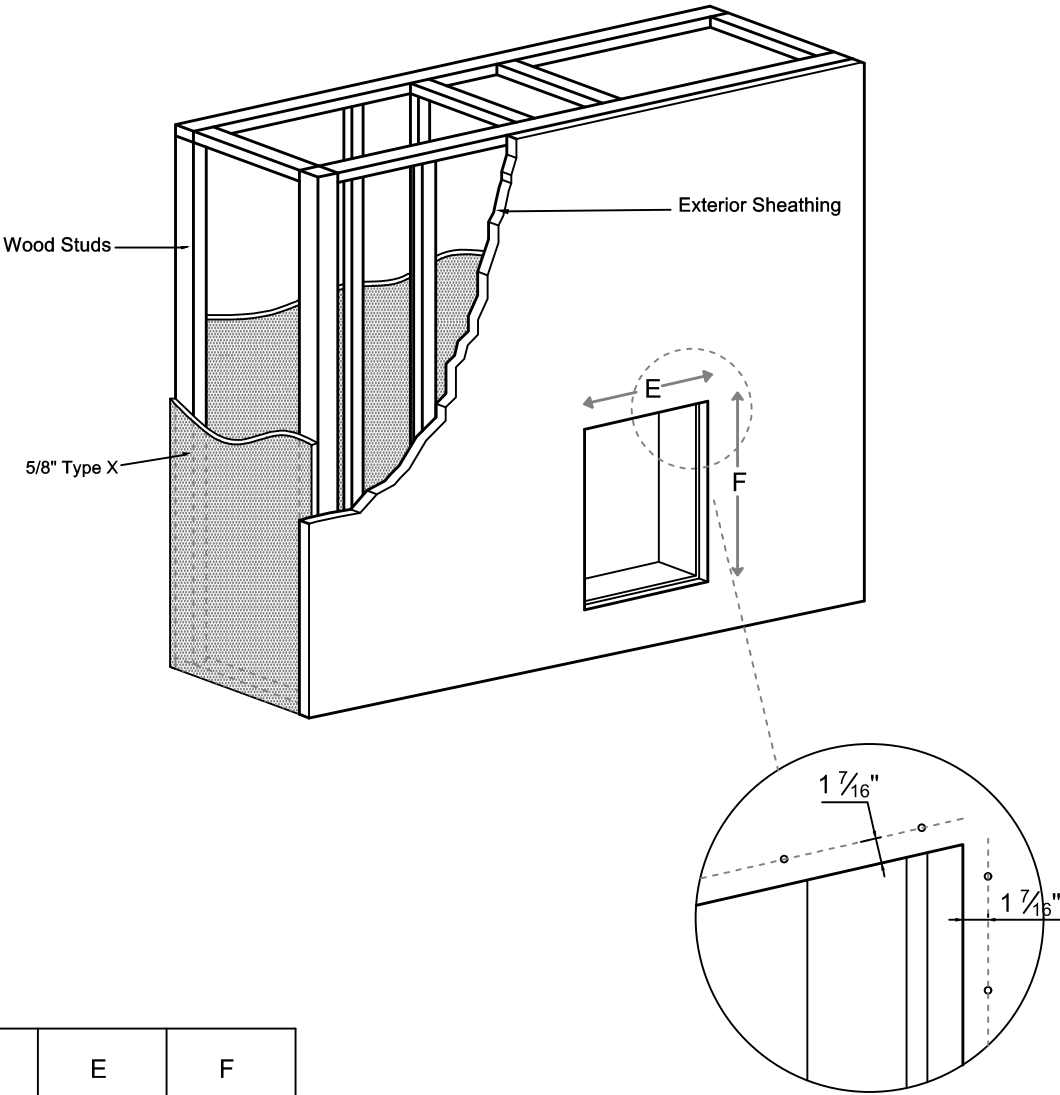

60X80 Indoor-Outdoor Double Glass - Flush

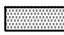

Model	E	F
60x80	24 3/8"	32 13/16"

Note : 1. Drawings are not to Scale
2. All dimensions in inches

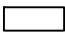
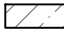
LEGEND

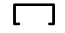
-  5/8" Type X
-  Steel
-  Wood
-  Glass
-  Wood Studs
-  Steel Studs

ORTAL
YOUR LIFE. YOUR FIRE

60X80 Indoor-Outdoor Double Glass - Flush

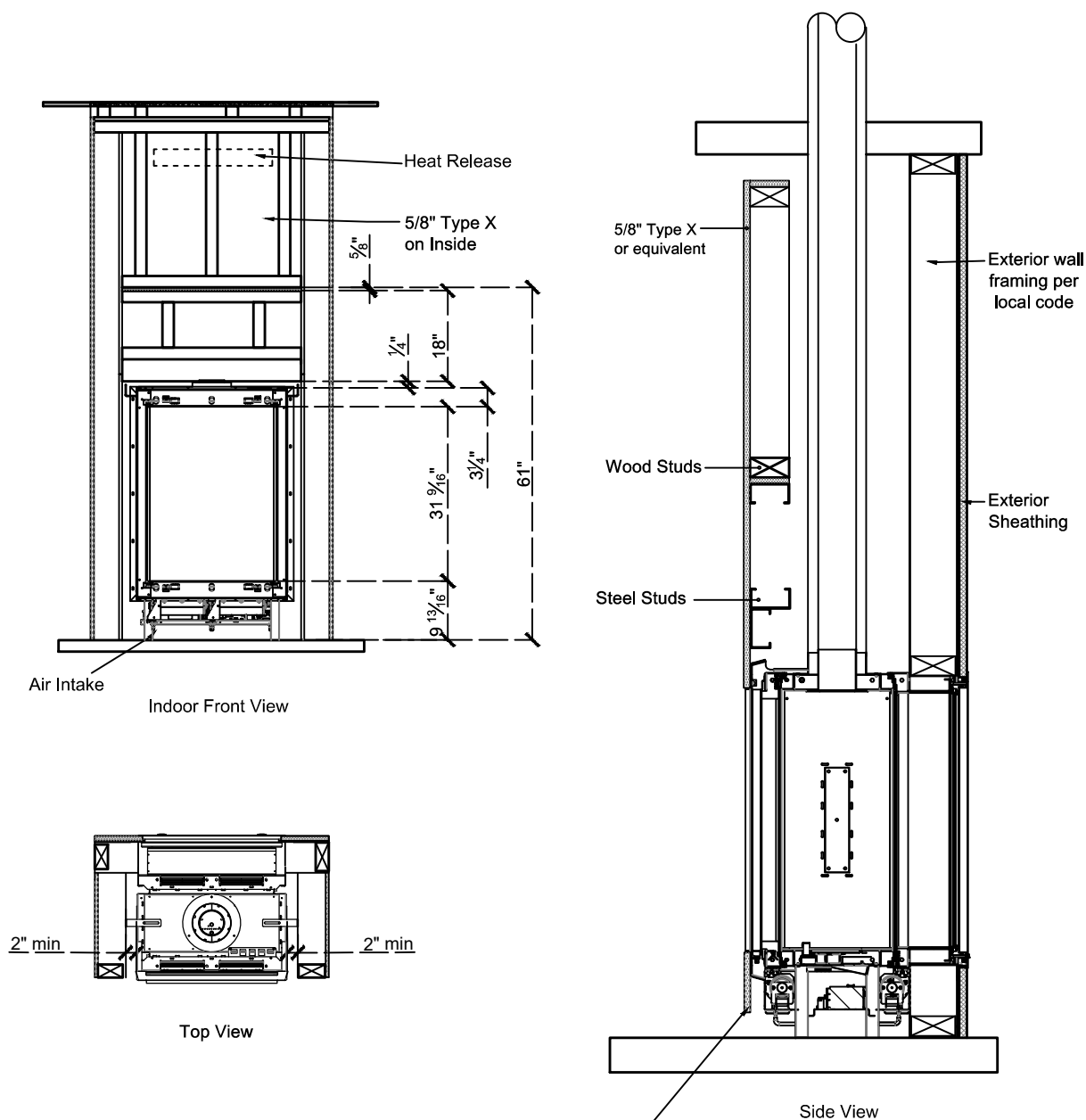

Add Drywall nailer as needed maintain 2" clearance to any part of Fireplace

Clearance 2" from each side to non combustible material

The valve can be moved 36" - 40" from the center of the fireplace in any direction

Note : 1. Drawings are not to Scale
2. All dimensions in inches